

# LF 3000® Push-In Fittings / Banjo Fittings



..... A modular solution designed to orientate the tube according to the application.

## Technical Characteristics

- **Compatible Fluids:** Compressed air  
Other fluids: please consult us
- **Working Pressure:** Vacuum to 20 bar
- **Working Temperature:** -20°C to +80°C

Tightening Torque (daN.m)	Threads					
	M3 x0.5	M5 x0.8	G1/8	G1/4	G3/8	G1/2
	0.05	0.1	0.4	0.5	0.6	0.7

Reliable performance is dependent upon the type of fluid conveyed, component materials and tubing being used.

Use is guaranteed with a vacuum of 755 mm Hg (99% vacuum).

## Advantages

- Screwed from above, for minimum space between connections
- 360° orientable
- Stacking of banjo bodies to allow construction of 2 to 6 outlets

## Component Materials

### Silicone-free

Bolt: nickel-plated brass, with or without pre-coating, depending on the configuration

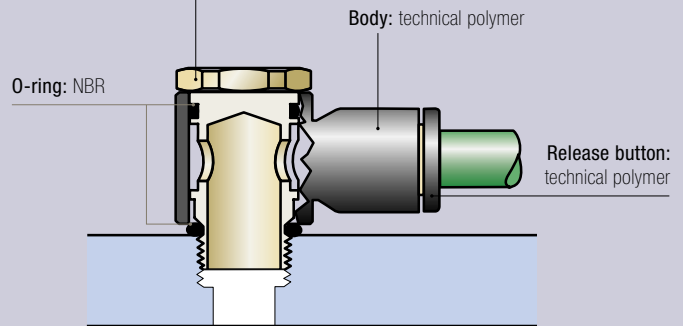

## Regulations

- ISO 14743
- PED
- RoHS
- REACH

## Installation Configurations

Thread and bore diameters for part numbers 3524 - 3527 - 3528 - 3529:

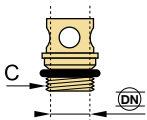

Thread (C)	M5x0.8	G1/8	G1/4	G3/8	G1/2
ØD	2.5	5.5	8.5	11	13

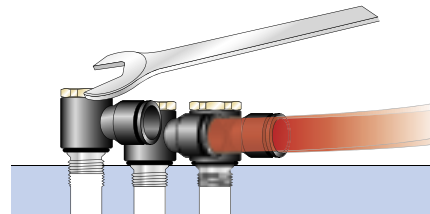

## 3549 Twin Banjo Bodies

Technical polymer, NBR

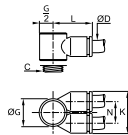

ØD	C		G	K	L	N	Kg
4	M5x0.8	<b>3549 04 19</b>	10	17.5	15.5	9	0.003
	G1/4	<b>3549 04 13</b>	18.5	28	25	14.5	0.020
	G1/8	<b>3549 06 10</b>	14	22.5	20.5	12	0.003
6	G1/4	<b>3549 06 13</b>	18.5	28	25	14.5	0.015
	G3/8	<b>3549 06 17</b>	22.5	33	28.5	17	0.031
8	G1/4	<b>3549 08 13</b>	18.5	28	26	14.5	0.006
	G3/8	<b>3549 08 17</b>	22.5	33	29.5	17	0.020
10	G3/8	<b>3549 10 17</b>	22.5	33	29.5	17	0.009

DYSTRYBUTOR PARKER PREMIUM

**ARA**<sup>®</sup>  
PNEUMATIK

| arapneumatik.pl

PARKER STORE WROCŁAW  
pneumatyka@arapneumatik.pl  
TEL. 71 364 72 80

PARKER STORE KATOWICE  
katowice@arapneumatik.pl  
TEL. 32 779 76 40

**Parker Store**