

# LF 3800 Push-In Fittings / Stud Fittings



Made of 316L stainless steel, this range is suitable for conveying corrosive or food fluids, in aggressive environments or for high hygiene requirements.

Ø metric: 4 to 12 mm  
Ø inch: 3/16" to 1/2"

## Technical Characteristics

- **Compatible Fluids:** All fluids compatible with the fitting component materials
- **Working Pressure:** Vacuum to 30 bar (20 bar: 3879 and 3889)
- **Working Temperature:** -25°C to +150°C

Adaptor Tightening Torque	Threads	M5 x0.8	G1/8	G1/4	G3/8	G1/2
	daN.m	0.16	0.8	1.2	3	3.5

Bulkhead Tightening Torque	Ø (mm)	4	6	8	10	12
	daN.m min. max.		0.5 0.9	0.5 0.9	0.6 1	0.6 1

Reliable performance is dependent upon the type of fluid conveyed, component materials and tubing being used.

Use is guaranteed with a vacuum of 755 mm Hg (99% vacuum).

Technical performance tested at -25°C according to the ISO 14743 standard.

## Regulations

- ISO 14743
- RoHS
- REACH
- FDA : 21 CFR
- PED

## Component Materials

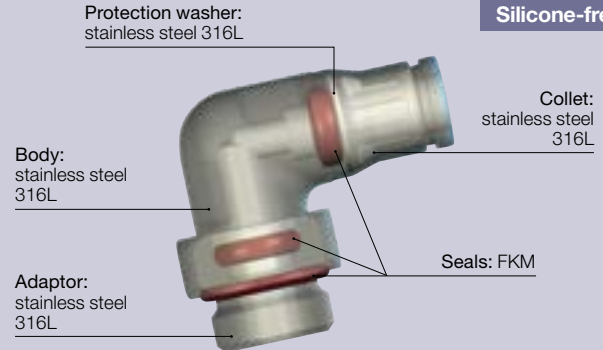

Silicone-free

## Advantages

- Resistance to corrosion thanks to the component material
- Suitable for permanent food contact
- Suitable for industrial cleaning agents and detergents
- Hygienic external design, for reducing retention zones

## 3800 Pre-Grooving Tool for Metallic Tubing

Treated steel

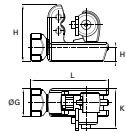

3800 70 00

G H H1 K L Kg

25 51 13 36 70 0.326

This tool correctly pre-grooves 4-12 mm O.D. and 3/16"-1/2" O.D. stainless steel tubing, to ensure that the LF 3800 collet grips the tube securely.

DYSTRYBUTOR PARKER PREMIUM

**ARA**<sup>®</sup>  
PNEUMATIK

| arapneumatik.pl

PARKER STORE WROCŁAW  
pneumatyka@arapneumatik.pl  
TEL. 71 364 72 80

PARKER STORE KATOWICE  
katowice@arapneumatik.pl  
TEL. 32 779 76 40

