

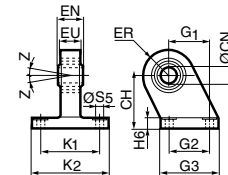

Type	Description	For mounting screws in stainless steel see page 51	Cyl. bore Ø mm	Weight kg	Order code
Pivot bracket with swivel bearing CS7 	Intended for use together with clevis bracket GA.		32	0,18	P1C-4KMA P1C-4LMA P1C-4MMA P1C-4NMA P1C-4PMA P1C-4QMA P1C-4RMA
	Material		40	0,25	
	Pivot bracket: Surface-treated steel, black		50	0,47	
	Swivel bearing acc. to DIN 648K: Hardened steel		63	0,57	
			80	1,05	
			100	1,42	
			125	3,10	

Cyl. bore mm	CN H7 mm	S5 H13 mm	K1 JS14 mm	K2 mm	EU mm	G1 JS14 mm	G2 JS14 mm	EN mm	G3 mm	CH JS15 mm	H6 mm	ER mm	Z 4°
32	10	6,6	38	51	10,5	21	18	14	31	32	10	16	4°
40	12	6,6	41	54	12,0	24	22	16	35	36	10	18	4°
50	16	9,0	50	65	15,0	33	30	21	45	45	12	21	4°
63	16	9,0	52	67	15,0	37	35	21	50	50	12	23	4°
80	20	11,0	66	86	18,0	47	40	25	60	63	14	28	4°
100	20	11,0	76	96	18,0	55	50	25	70	71	15	30	4°
125	30	14,0	94	124	25,0	70	60	37	90	90	20	40	4°



3 and 4 positions flange JP1	Mounting kit for back to back mounted cylinders, 3 and 4 position cylinders.		Cyl. bore mm	Weight kg	Order code
	Material:		32	0,060	P1E-6KB0 P1E-6LB0 P1E-6MB0 P1E-6NB0 P1E-6PB0 P1E-6QB0
	Mounting: Aluminium		40	0,078	
	Mounting screws: Zinc-plated steel 8.8		50	0,162	
			63	0,194	
			80	0,450	
			100	0,672	

Cyl. bore mm	E mm	TG mm	ØFB mm	MF mm	A mm	ØBA mm
32	50	32,5	6,5	5	16	30
40	60	38,0	6,5	5	16	35
50	66	46,5	8,5	6	20	40
63	80	56,5	8,5	6	20	45
80	100	72,0	10,5	8	25	45
100	118	89,0	10,5	8	25	55

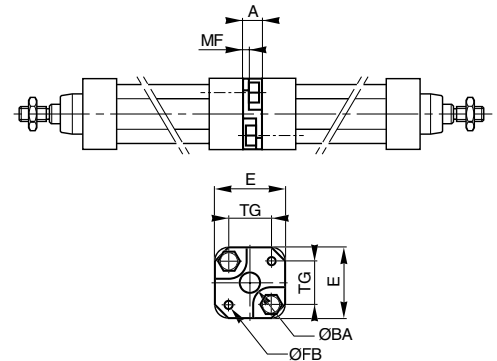

Pivot brackets AT4 for MT* trunnion	Intended for use together with centre trunnion MT4.		Cyl. bore mm	Weight kg	Order code
	Material		32	0,04*	9301054261 9301054262 9301054262 9301054262 9301054264 9301054264 9301054266 9301054266
	Pivot bracket: Surface-treated aluminium		40	0,07*	
	Bearing acc. to DIN 1850 C: Sintered oil-bronze bushing		50	0,07*	
			63	0,12*	
			80	0,12*	
			100	0,21*	
			125	0,21*	

* Weight per item.

Cyl. bore mm	B1 mm	B2 mm	A mm	C mm	d1 mm	d2 H13 mm	H1 mm	H2 mm	fx45° min
32	46	18,0	32	10,5	12	6,6	30	15	1,0
40	55	21,0	36	12,0	16	9,0	36	18	1,6
50	55	21,0	36	12,0	16	9,0	36	18	1,6
63	65	23,0	42	13,0	20	11,0	40	20	1,6
80	65	23,0	42	13,0	20	11,0	40	20	1,6
100	75	28,5	50	16,0	25	14,0	50	25	2,0
125	75	28,5	50	16,0	25	14,0	50	25	2,0

