





Type	Description	For mounting screws in stainless steel see page 51	Cyl. bore Ø mm	Weight kg	Order code
<b>Centre trunnion MT4 for P1D-S</b> 	Intended for articulated mounting of cylinder. This mounting is available for the P1D Standard and for the tie-rod design of P1D. The trunnion is factory-fitted in the centre of the cylinder or at an optional location specified by the XV-measure – see the order code key. Combined with pivot bracket for MT4. Material: Trunnion: zinc plated steel		32	0,13	<b>See order code key</b>
			40	0,31	
			50	0,37	
			63	0,69	
			80	0,89	
			100	1,58	
<b>Centre trunnion MT4 for P1D-T</b> 	<b>Trunnion centred</b> The centre trunnion for the P1D-S and P1D-T is ordered with letter D in position 17 (no dimension specified in positions 18-20). See the order code key. <b>Trunnion with optional location</b> The centre trunnion for the P1D-S and P1D-T is ordered with letter G in position 17 and desired XV-measure (3-digit measure in mm) in positions 18-20. See the order code key. <b>Trunnion loose</b> P1D-S can also be ordered with the centre trunnion loosely fitted to the cylinder (not fixed in position). This allows the position to be established at the time of installation. Ordered with letter G in position 17 and 000 in positions 18-20. Please refer to the order code key.		32	0,13	
			40	0,31	
			50	0,37	
			63	0,69	
			80	0,89	
			100	1,58	

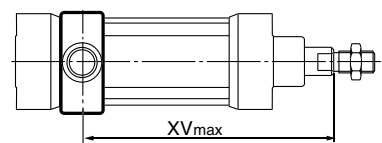
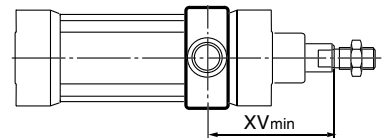
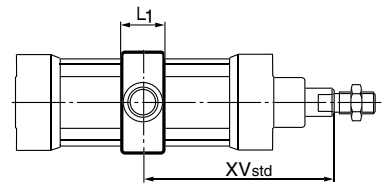
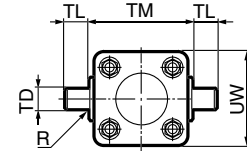

Cyl. bore mm	TM h14 mm	TL h14 mm	TD e9 mm	R mm	UW mm		L1 mm		X1* mm	XV <sub>min</sub> P1D-S mm	XV <sub>min</sub> P1D-T mm	XV <sub>min</sub> P1D-L mm	X2 P1D-S mm	X2 P1D-T mm	X2 P1D-L mm
					P1D-S	P1D-T	P1D-S	P1D-T							
32	50	12	12	1,0	52	46	18	15	73,0	89	62	121	57	84	88
40	63	16	16	1,6	59	59	20	20	82,5	95	73	125	70	92	99
50	75	16	16	1,6	71	69	20	20	90,0	113	81	140	67	99	93
63	90	20	20	1,6	84	84	26	25	97,5	118	89	155	78	106	114
80	110	20	20	1,6	105	102	26	25	110,0	132	98	177	88	122	132
100	132	25	25	2,0	129	125	32	30	120,0	140	111	197	100	129	156
125	160	25	25	2,0	159	155	33	32	145,0	168	132	224	122	158	177

XVstd = X1 + Stroke length/2, XVmax = X2 + Stroke length

<b>Flange trunnion MT5/MT6</b> 	Intended for articulated mounting of cylinder. This trunnion can be flange mounted on the front or rear end cover of all P1D cylinders. At your choice, you can order a complete cylinder with factory-fitted flange mounted trunnion – see the order code key. Individual trunnions have order code as shown to the right.		32	0,17	<b>P1D-4KMYF</b>			
						40	0,43	<b>P1D-4LMYF</b>
						50	0,55	<b>P1D-4MMYF</b>
						63	1,10	<b>P1D-4NMYF</b>
						80	1,66	<b>P1D-4PMYF</b>
						100	3,00	<b>P1D-4QMYF</b>

Material:  
Trunnion: zinc plated steel  
Screws: zinc plated steel, 8.8

Delivered complete with mounting screws for attachment to the cylinder

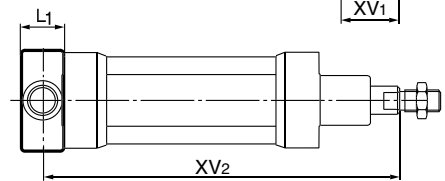
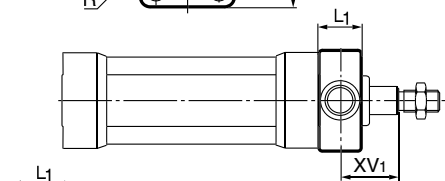
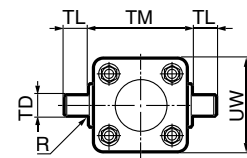

Cyl. bore mm	TM h14 mm	TL h14 mm	TD e9 mm	R mm	UW mm	L1 mm	XV <sub>1</sub> mm	X* mm	Y mm
32	50	12	12	1,0	46	14	19,5	126,5	11
40	63	16	16	1,6	59	19	21,0	144,0	14
50	75	16	16	1,6	69	19	28,0	152,0	20
63	90	20	20	1,6	84	24	25,5	169,5	20
80	110	20	20	1,6	102	24	34,5	185,5	26
100	132	25	25	2,0	125	29	37,0	203,0	31

XV<sub>2</sub> = X + Stroke length \* Does not apply to cylinders with lock unit,

To fit a flange mounted trunnion at the front end cover of a P1D cylinder with lock unit, the piston rod must be extended. This is in order to provide the same WH dimensions as for the P1D base cylinder with dimension Y.