

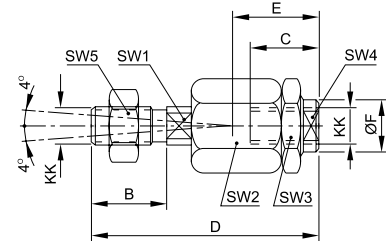

Type	Description	Cyl. bore Ø mm	Weight kg	Order code
Flexo coupling PM5 	Flexo coupling for articulated mounting of piston rod. Flexo fitting is intended to take up axial angle errors within a range of ±4°.	32	0,21	P1C-4KRF P1C-4LRF P1C-4MRF P1C-4MRF P1C-4PRF P1C-4PRF P1C-4RRF
		40	0,22	
	50	0,67		
	63	0,67		
	80	0,72		
	100	0,72		
	125	1,80		
	Material Flexo coupling, nut: Zinc-plated steel			

Supplied complete with galvanized adjustment nut.

Cyl. bore mm	KK mm	B mm	C mm	D mm	E mm	ØF mm	SW1 mm	SW2 mm	SW3 mm	SW4 mm	SW5 mm
32	M10x1.25	20	23	73	31	21	12	30	30	19	17
40	M12x1.25	24	23	77	31	21	12	30	30	19	19
50	M16x1.5	32	32	108	45	33.5	19	41	41	30	24
63	M16x1.5	32	32	108	45	33.5	19	41	41	30	24
80	M20x1.5	40	42	122	56	33.5	19	41	41	30	30
100	M20x1.5	40	42	122	56	33.5	19	41	41	30	30
125	M27x2	54	48	147	51	39	24	55	55	32	41



Nut MR9 	Intended for fixed mounting of accessories to the piston rod. Material: Zinc-plated steel	32	0,007	P14-4KRPZ P14-4LRPZ P14-4MRPZ P14-4MRPZ P14-4PRPZ P14-4PRPZ P14-4RRPZ
		40	0,010	
	50	0,021		
	63	0,021		
	80	0,040		
	100	0,040		
	125	0,100		

Stainless steel nut MR9 	Intended for fixed mounting of accessories to the piston rod. Material: Stainless steel A2	32	0,007	P14-4KRPS P14-4LRPS P14-4MRPS P14-4MRPS P14-4PRPS P14-4PRPS P14-4RRPS
		40	0,010	
	50	0,021		
	63	0,021		
	80	0,040		
	100	0,040		
	125	0,100		

Acid-proof nut MR9 	Intended for fixed mounting of accessories to the piston rod. Material: Acid-proof steel A4	32	0,007	P14-4KRPX P14-4LRPX P14-4MRPX P14-4MRPX P14-4PRPX P14-4PRPX P14-4RRPX
		40	0,010	
	50	0,021		
	63	0,021		
	80	0,040		
	100	0,040		
	125	0,100		

According to DIN 439 B

Cyl. bore mm	A mm	B mm	C
32	17	5,0	M10x1,25
40	19	6,0	M12x1,25
50	24	8,0	M16x1,5
63	24	8,0	M16x1,5
80	30	10,0	M20x1,5
100	30	10,0	M20x1,5
125	41	13,5	M27x2

Supplied as pack of 10 off
Weight per item

