

Brass Adaptors

0126 Plug for Compression Fitting

Brass

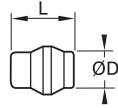

ØD		L	Kg
4	0126 04 00	10	0.002
5	0126 05 00	10	0.003
6	0126 06 00	10	0.003
8	0126 08 00	11.5	0.006
10	0126 10 00	13	0.010
12	0126 12 00	13	0.014
14	0126 14 00	13.5	0.020
15	0126 15 00	13.5	0.022
16	0126 16 00	16	0.030
18	0126 18 00	16	0.038
20	0126 20 00	16	0.045
22	0126 22 00	18	0.003
28	0126 28 00	19.5	0.108

The plug is used to blank off an outlet in a compression fitting, replacing the olive.

When an open outlet is required, simply dismantle and replace the plug with the tube olive, reusing the nut. The plug is also reusable.

0125 Tube End Plug for Compression Fitting

Brass

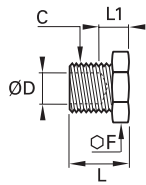

ØD	C		F	L	L1	Kg
4	M8x1	0125 04 00	10	12	8	0.006
6	M10x1	0125 06 00	11	13.5	9.5	0.008
8	M12x1	0125 08 00	14	14	9	0.012
10	M16x1.5	0125 10 00	17	18	11	0.025
12	M18x1.5	0125 12 00	19	18	11	0.030
14	M20x1.5	0125 14 00	22	19	11	0.041

This plug enables unused tubes to be blanked off.

The male thread on the plug has the same pitch as the female thread on the sleeve nut of a standard Parker Legris fitting.

Therefore the plug screwed into the sleeve nut blanks off the tube.

To reopen the passage, simply unscrew the plug and fit the required coupler.

No further treatment of the tube is required.

0220 Hex Head Plug, Male BSPP and Metric Thread

Brass, technical polymer

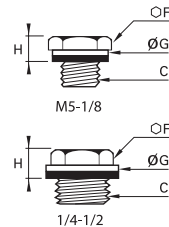

C		F	G	H1	Kg
M5x0.8	0220 19 00	8	8	5	0.002
G1/8	0220 10 00	14	14	7.5	0.011
G1/4	0220 13 00	17	17	7.5	0.020
G3/8	0220 17 00	17	22	8.5	0.024
G1/2	0220 21 00	22	27	10	0.041

Thread with pre-assembled sealing washer

M5: with screwdriver slot for tightening

Maximum allowable working pressure = 20 bar

Part number with suffix 99, maximum allowable working pressure = 250 bar, example: 0220 19 00 99

Conforms to BNA 229 (with the exception of M5 model), BSPP thread, ISO ISO 228-1,

Parallel metric thread, ISO NFE 03-054

0220..39 Hex Head Plug with Bi-Material Seal, Male BSPP Thread

Brass, zinc-plated steel with NBR seal

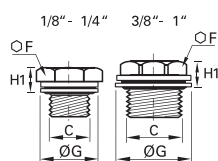

C		F	G	H	Kg
G1/8	0220 10 00 39	14	14	6.5	0.012
G1/4	0220 13 00 39	17	17	6.5	0.020
G3/8	0220 17 00 39	17	22	8	0.025
G1/2	0220 21 00 39	22	26	9	0.043
G3/4	0220 27 00 39	22	32	10	0.060
G1	0220 34 00 39	27	39.5	10.5	0.089

Plug with bi-material seal

Bi-material washers part number 0139 can be found in chapter 9.

Brass Adaptors

0120

Stud Standpipe, Male BSPT Thread

Brass

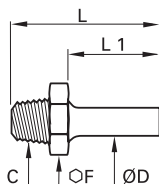

ØD	C		F	L	L1	Kg
4	R1/8	0120 04 10	11	25.5	14	0.007
5	R1/8	0120 05 10	11	26	14.5	0.007
6	R1/8	0120 06 10	11	26.5	15	0.008
	R1/4	0120 06 13	14	31	15	0.015
8	R1/8	0120 08 10	11	28.5	17	0.009
	R1/4	0120 08 13	14	33	17	0.016
	R3/8	0120 08 17	17	33.5	17	0.020
10	R1/4	0120 10 13	14	36	20	0.018
	R3/8	0120 10 17	17	36.5	20	0.022
12	R1/2	0120 10 21	22	41	20	0.040
	R1/4	0120 12 13	14	36	20	0.018
14	R3/8	0120 12 17	17	36.5	20	0.022
	R1/2	0120 12 21	22	41	20	0.040
15	R3/8	0120 14 17	17	38	21.5	0.023
	R1/2	0120 14 21	22	42.5	21.5	0.041
16	R3/8	0120 15 17	17	38	21.5	0.023
	R1/2	0120 15 21	22	42.5	21.5	0.041
18	R3/8	0120 16 17	17	39.5	23	0.024
	R1/2	0120 16 21	22	44	23	0.042
20	R1/2	0120 18 21	22	44.5	23.5	0.042
	R3/4	0120 18 27	27	47.5	23.5	0.071
22	R3/4	0120 20 27	27	49	25	0.070
	R3/4	0120 22 27	27	48.5	25.5	0.067
25	R1	0120 22 34	36	52.5	25.5	0.117
28	R1	0120 25 34	36	57	30	0.118
		0120 28 34	36	57	30	0.140

0112

Sleeve Nut for Compression Fitting, Male Metric Thread

Brass

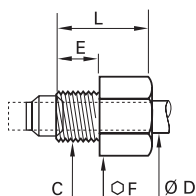

ØD	C		E	F	L	Kg
4	M8x1	0112 04 00	7	10	13	0.005
5	M10x1	0112 05 00	7.5	11	13.5	0.007
6	M10x1	0112 06 00	7.5	11	13.5	0.006
8	M12x1	0112 08 00	8	13	15	0.009
10	M16x1.5	0112 10 00	11	17	18	0.018
12	M18x1.5	0112 12 00	11	19	18	0.021
14	M20x1.5	0112 14 00	11	22	18	0.026

This product was designed to allow the tube to be fitted directly into the tapped port in a body using a standard Parker Legris olive.

For the corresponding drawings (cavity for Parker Legris olive), please consult us.

ARA®

PNEUMATIK

53-012 Wrocław tel. 71 364 72 82
ul. Wyścigowa 38 fax 71 364 72 83

www.arapneumatik.pl



Brass Adaptors

0128..39 Stud Standpipe with Bi-Material Seal, Male BSPP Thread

Brass, zinc-plated steel with NBR seal

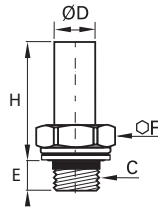

ØD	C		E	F	H	Kg
4	G1/8	0128 04 10 39	7.5	13	20	0.009
	G1/4	0128 04 13 39	9	17	22	0.015
6	G1/8	0128 06 10 39	7.5	13	21	0.010
	G1/4	0128 06 13 39	9	17	23	0.016
8	G1/8	0128 08 10 39	7.5	13	23	0.011
	G1/4	0128 08 13 39	9	17	25	0.017
	G3/8	0128 08 17 39	12	22	26	0.032
10	G1/4	0128 10 13 39	9	17	28	0.018
	G3/8	0128 10 17 39	12	22	29	0.034
14	G1/2	0128 10 21 39	27	27	30	0.049
	G3/8	0128 14 17 39	12	22	30.5	0.035
18	G1/2	0128 14 21 39	27	27	31.5	0.049
	G3/4	0128 18 21 39	27	27	33.5	0.051
22	G3/4	0128 18 27 39	14	32	34.5	0.084
	G1	0128 22 27 39	14	32	36.5	0.082
28	G1	0128 22 34 39	16.5	41	38	0.123
	G1	0128 28 34 39	16.5	41	42.5	0.147

With bi-material seal. Bi-material washers part number 0139 can be found in Chapter 9.

0151..39 Straight Male Orientable Adaptor, with Bi-Material Seal, Male BSPP Thread

Brass, NBR, zinc-plated steel with NBR seal

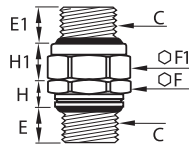

C		E	E1	F	F1	H	H1	Kg
G1/8	0151 10 10 39	5.5	7	13	14	6	6.5	0.017
G1/4	0151 13 13 39	7	8.5	17	19	6.5	9	0.036
G3/8	0151 17 17 39	9.5	9.5	22	22	9	9	0.056
G1/2	0151 21 21 39	10.5	10.5	27	27	10	10	0.083
G3/4	0151 27 27 39	11.5	11.5	32	32	11	10	0.121
G1	0151 34 34 39	13	13.5	41	41	12.5	10.5	0.217

With bi-material seal.

Bi-material washers part number 0139 can be found in Chapter 9.

0168..39 Reducer, with Bi-Material Seal, Male BSPP Thread/Female BSPP and Metric Thread

Brass, zinc-plated steel with NBR seal

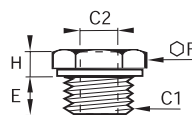

C1	C2		E	F	H	Kg
G1/8	M5x0.8	0168 10 19 39	8	14	4.5	0.009
	M5x0.8	0168 13 19 39	8	17	5	0.018
G1/4	G1/8	0168 13 10 39	8	17	5	0.012
	G1/8	0168 17 10 39	10	19	5	0.020
G3/8	G1/4	0168 17 13 39	10	19	5	0.013
	G1/8	0168 21 10 39	12	24	7.5	0.052
G1/2	G1/4	0168 21 13 39	12	24	7.5	0.044
	G3/8	0168 21 17 39	12	24	7.5	0.031
G3/4	G1/4	0168 27 13 39	12	32	9.5	0.100
	G3/8	0168 27 17 39	12	32	9.5	0.086
	G1/2	0168 27 21 39	12	32	9.5	0.065

With bi-material seal.

Bi-material washers part number 0139 can be found in Chapter 9.

Brass Adaptors

0127

Brass Tube Support for Polymer Tubing

Brass

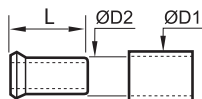

	ØD1	ØD2		L	Kg
4	2		0127 04 00	11	0.001
	2.7		0127 04 27	11	0.001
5	3		0127 05 03	11	0.001
	3.3		0127 05 00	11.5	0.009
6	4		0127 06 00	11.5	0.001
	5.5		0127 08 55	14	0.001
8	6		0127 08 00	14	0.001
	7		0127 10 07	18	0.001
10	7.5		0127 10 75	18	0.001
	8		0127 10 00	18	0.002
12	8		0127 12 08	18	0.002
	9		0127 12 09	18	0.002
	10		0127 12 00	18	0.001
14	11		0127 14 11	18	0.002
	12		0127 14 00	18	0.002
15	12		0127 15 12	18	0.002
16	13		0127 16 13	18	0.003
18	14		0127 18 14	19.5	0.003
20	15		0127 20 15	20.5	0.003
22	16		0127 22 16	21	0.004
25	19		0127 25 19	25	0.007

This tube support guarantees good gripping, at high temperatures and pressures, by preventing collapsing of the tube.

ARA®

PNEUMATIK

53-012 Wrocław tel. 71 364 72 82
ul. Wyścigowa 38 fax 71 364 72 83

www.arapneumatik.pl

