

ISO 9001:2008 by L.R.
PED DIR. 97/23/EC by L.R.
ATEX DIR. 94/9/EC by B.V.
FIRE SAFE EXECUTION by L.R.
ISO 15848 by TÜV
ANTISTATIC DEVICE by L.R.
FIRE SAFE TESTED ISO 10497 by L.R.

WWW.ADLERSPA.COM

TYPE
FX1
PN 10 ÷ 40
ANSI 150 ÷ 300

BALL VALVES "WAFER TYPE" FULL BORE WITH HEATING JACKET
ROBINETS A BOULE "WAFER" PASSAGE INTEGRAL AVEC
ENVELOPPE
FLANSCHKUGELHÄHNE IN "KOMPAKTBAUWEISE"
VOLLER DURCHGANG MIT HEIZMANTEL

ISO nbr° LRC 0160281 QMS issued by L.R.Q.A. PED nbr° COV 0212112/01 issued by L.R.V.
ATEX nbr° 40.2003.4392 issued by B.V. ISO 15848 nbr° I-148466/1-/2 issued by TÜV

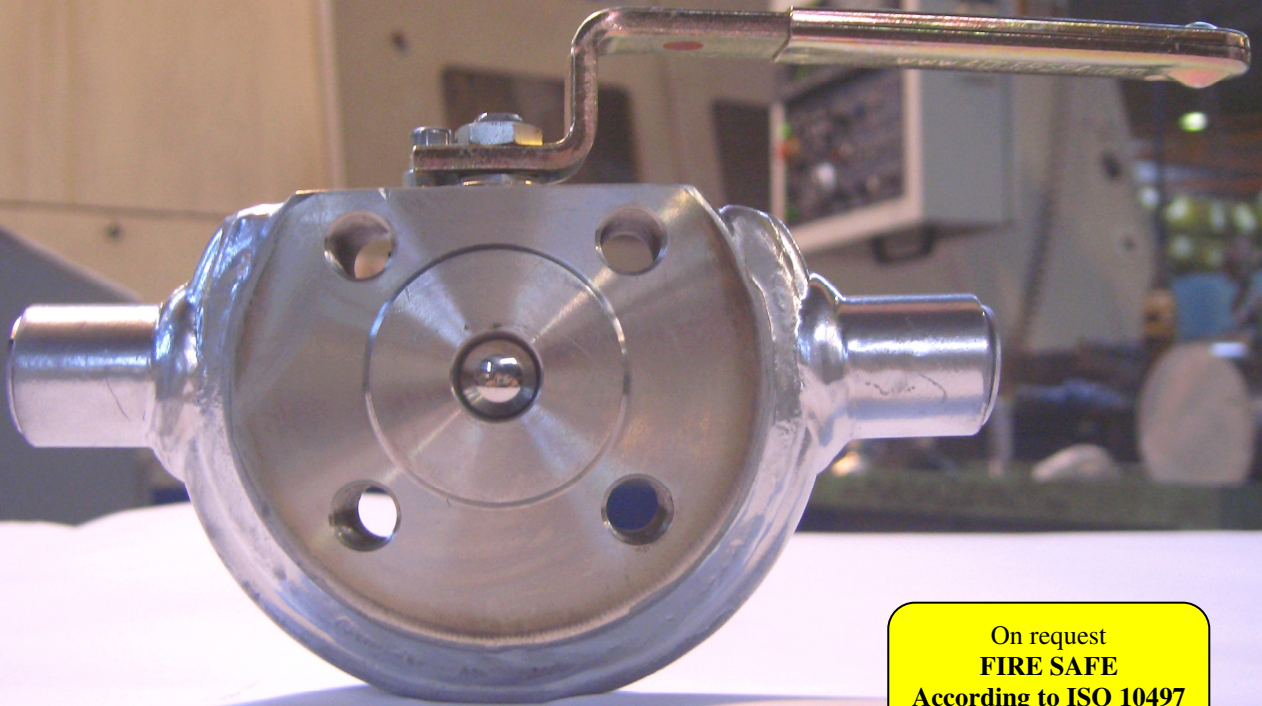

On request
FIRE SAFE
According to ISO 10497
"ISO-FT"

CONSTRUCTION IN ACCORDING TO:
BS EN 12516-2 - ANSI B16.34
ISO 14313



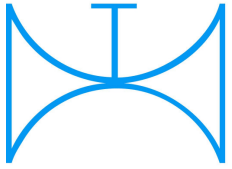

ISO 9001:2008 by L.R.
 PED DIR. 97/23/EC by L.R.
 ATEX DIR. 94/9/EC by B.V.
 FIRE SAFE EXECUTION by L.R.
 ISO 15848 by TÜV
 ANTISTATIC DEVICE by L.R.
 FIRE SAFE TESTED ISO 10497 by L.R.

TYPE
FX1
 PN 10 ÷ 40
 ANSI 150 ÷ 300

VALVOLA A SFERA "CORPO PIATTO" PASSAGGIO TOTALE CON CAMICIA DI RISCALDAMENTO
 BALL VALVES "WAFER TYPE" FULL BORE WITH HEATING JACKET
 ROBINETS A BOULE "WAFER" PASSAGE INTEGRAL AVEC ENVELOPPE
 FLANSCHKUGELHÄHNE IN "KOMPAKTBAUWEISE" VOLLER DURCHGANG MIT HEIZMANTEL

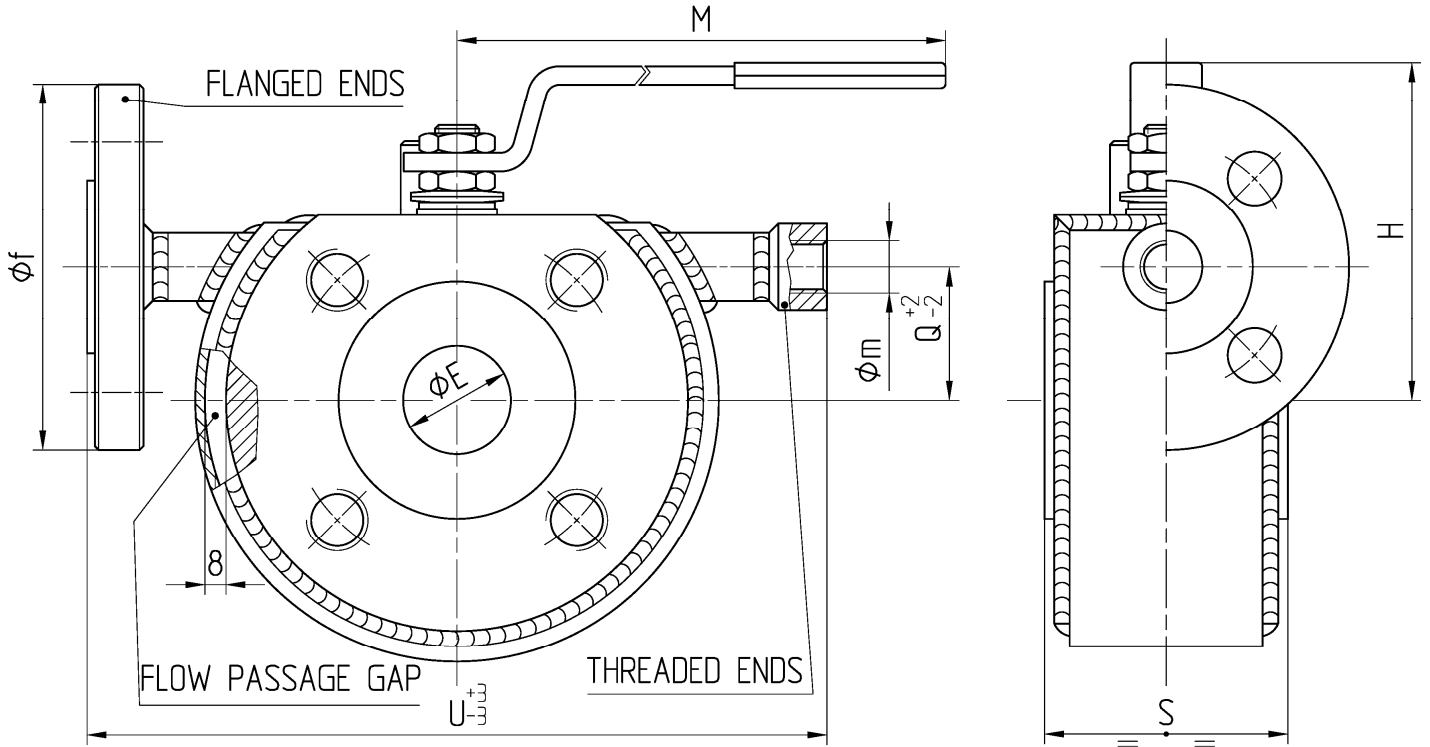

Valvola base FA1
 Main Ball Valve FA1

Pressione massima di lavoro nelle camicie 10 bar
 Maximum working pressure for jacket 10 bar

CONSTRUCTION IN ACCORDING TO:
 BS EN 12516-2 - ANSI B16.34
 ISO 14313

| | |
|--------------------------------------|---|
| Materiale camicia Jacket material | CARBON STEEL (STANDARD) STAINLESS STEEL (OPTIONAL) |
|--------------------------------------|---|

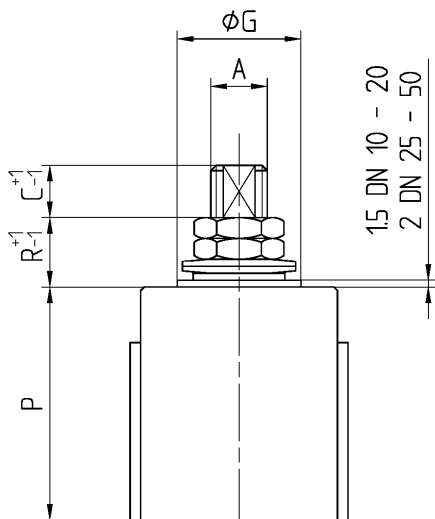

• ACCOPPIAMENTO VALVOLA
 ATTUATORE
 • CONNECTION VALVE
 ACTUATOR
 • ACCOUPLEMENT ROBINET-
 ACTIONNEUR
 • ZUSAMMENBAU KUGELHAHN
 ANTRIEB
ISO-5211

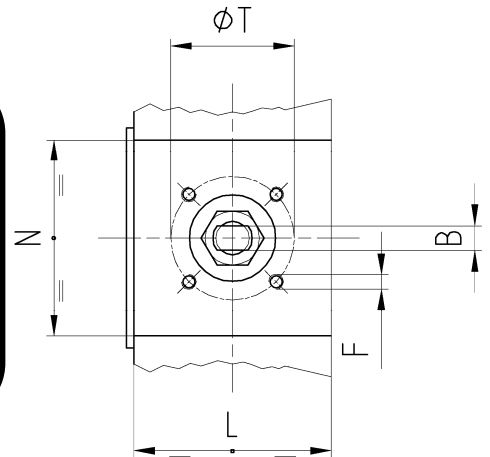

| N. | DESCRIZIONE DESCRIPTION BESCHREIBUNG | MATERIALI MATERIALS MATERIAUX WERKSTOFFE |
|----|--|---|
| 1 | CORPO BODY CORPS KÖRPER | ASTM A105 ASTM A 182 F304- A479 S30400 ASTM A 182 F316- A479 S31600 |
| 2 | GHIERA INSERT EMBOUT GEWINDED RUCKRING | ASTM A105 ASTM A 182 F304- A479 S30400 ASTM A 182 F316- A479 S31600 |
| 3* | O-RING | FKM - (VITON) |
| 4* | ANELLO SEAL ANNEAU DICHTUNGSRING | P.T.F.E. |
| 5* | SEDE SEAT SIEGE SITZRING | P.T.F.E. + 15% FIBERGLASS |
| 6 | SFERA BALL BOULE KUGEL | ASTM A182 F304-A479 S30400 ASTM A351 CF8 ASTM A182 F316-A479 S31600 ASTM A351 CF8M |
| 7 | DISPOSITIVO ANTISTATICO ANTISTATIC DEVICE CONTACT ANTISTATIQUE ANTISTATIK VORRICHTUNG | ASTM A479 S31600 |
| 8 | STELO STEM TIGE SPINDEL | ASTM A182 F304 ≥ DN 40 A479 S30400 ASTM A182 F316 A479 S31600 |

| N. | DESCRIZIONE DESCRIPTION BESCHREIBUNG | MATERIALI MATERIALS MATERIAUX WERKSTOFFE |
|-----|--|--|
| 9* | BUSSOLA STEM SEAL JOINT TIGE UNTERE SPINDELABDICHTUNG | P.T.F.E. |
| 10* | PACCO A "V" CHEVRON RINGS JOINT A "V" 3 FACHE DACHMANSCHETTE | P.T.F.E. / GRAFITE P.T.F.E. / GRAPHITE P.T.F.E. / GRAPHITE P.T.F.E. / GRAPHIT |
| 11 | PREMIBUSSOLA PRESSING BUSH PRESSE RONDELLE STOPFBUCHSDRUCKRING | ASTM A479 S31600 |
| 12 | MOLLE A TAZZA SPRING WASHERS RONDELLES BELLEVILLE TELLERFEDERN | C72/50Cr V4 ZINCATO - GALVANIZED ZINGUE - VERZINKT |
| 13 | VITE DI FERMO E FERMO PIN AND STOP PIN PLOT ET PLOT D'ARRET ANSCHLAGBOLZEN | UNI 3740 - 8.8 ZINCATO - GALVANIZED ZINGUE - VERZINKT |
| 14 | DADO - CONTRODADO NUT - LOCK NUT ECROU - CONTRE-ECROU MUTTER - KONTERMUTTER | UNI 3740 - 6S ZINCATO - GALVANIZED ZINGUE - VERZINKT |
| 15 | LEVA WRENCH LEVIER HANDHEBEL | UNI 5946 Fe 37 ZINCATO - GALVANIZED ZINGUE - VERZINKT |
| 16 | | |

* RICAMBI CONSIGLIATI - RECOMMENDED SPARE PARTS - PIECES DE RECHANGE CONSEILLEES - ERSATZTEIL EMPFEHLUNG

DIMENSIONI - DIMENSION - DIMENSIONS - ABMESSUNGEN

| DN | 10 | 15 | 20 | 25 | 32 | 40 | 50 | 65 | 80 | 100 | 125 | 150 | 200 | 250 | 300 |
|-----|-------------|------|------|------|------|------|------|----|----|-----|-----|-----|-----|-----|-----|
| A | 10 | 10 | 10 | 12 | 12 | 16 | 16 | | | | | | | | |
| B | 6 | 6 | 6 | 8 | 8 | 10 | 10 | | | | | | | | |
| C | 7 | 7 | 7 | 10 | 10 | 10 | 10 | | | | | | | | |
| E | 15 | 15 | 19 | 25 | 30 | 38 | 51 | | | | | | | | |
| F | M5 | M5 | M5 | M5 | M5 | M6 | M6 | | | | | | | | |
| f | DN 15 PN 16 | | | | | | | | | | | | | | |
| ISO | F03 | F03 | F03 | F03 | F03 | F05 | F05 | | | | | | | | |
| G | 25 | 25 | 25 | 25 | 25 | 35 | 35 | | | | | | | | |
| H | 66 | 66 | 68 | 85 | 91 | 110 | 120 | | | | | | | | |
| L | 33 | 33 | 33 | 40 | 48 | 58 | 79 | | | | | | | | |
| M | 145 | 145 | 145 | 185 | 185 | 280 | 280 | | | | | | | | |
| m | Ø1/2" GAS | | | | | | | | | | | | | | |
| N | 69 | 69 | 78 | 81 | 105 | 102 | 102 | | | | | | | | |
| P | 32,5 | 32,5 | 35 | 41 | 46,5 | 55 | 65 | | | | | | | | |
| Q | | | | | 25 | 30 | 30 | | | | | | | | |
| R | 7,5 | 7,5 | 7,5 | 16,5 | 16,5 | 19,5 | 19,5 | | | | | | | | |
| P | 32,5 | 32,5 | 36,5 | 42,5 | | 55 | 74,5 | | | | | | | | |
| R | 8 | 8 | 6 | 17 | | 20 | 10 | | | | | | | | |
| S | 35 | 35 | 35 | 43 | 51 | 64 | 85 | | | | | | | | |
| T | 36 | 36 | 36 | 36 | 36 | 50 | 50 | | | | | | | | |
| U | 170 | 170 | 180 | 190 | 210 | 230 | 250 | | | | | | | | |
| Kg | 2,6 | 2,6 | 2,9 | 3,8 | 5,3 | 8,7 | 13 | | | | | | | | |

- DATI E CARATTERISTICHE SOGGETTI A VARIAZIONI SENZA PREAVVISO
- SPECIFICATIONS SUBJECT TO MODIFICATION WITHOUT PRIOR NOTICE
- TOUS DROITS DE MODIFICATION RESERVES
- KONSTRUKTIONÄNDERUNGEN VORBEHALTEN

PN 10 ÷ 40 - ANSI 150

ANSI 300



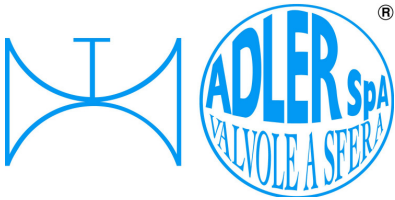

ISO 9001:2008 by L.R.
 PED DIR. 97/23/EC by L.R.
 ATEX DIR. 94/9/EC by B.V.
 FIRE SAFE EXECUTION by L.R.
 ISO 15848 by TÜV
 ANTISTATIC DEVICE by L.R.
 FIRE SAFE TESTED ISO 10497 by L.R.

TYPE
FA1
 PN 10 ÷ 40
 ANSI 150 ÷ 300

VALVOLA A SFERA "CORPO PIATTO" PASSAGGIO TOTALE CON CAMICIA DI RISCALDAMENTO
 BALL VALVES "WAFER TYPE" FULL BORE WITH HEATING JACKET

ROBINETS A BOULE "WAFER" PASSAGE INTEGRAL AVEC ENVELOPPE
 FLANSCHKUGELHÄHNE IN "KOMPAKTBAUWEISE" VOLLER DURCHGANG MIT HEIZMANTEL

▪ ESECUZIONI ▪ EXECUTIONS ▪ EXECUTIONS ▪ AUSFÜHRUNGEN



EXECUTION 4 - 12

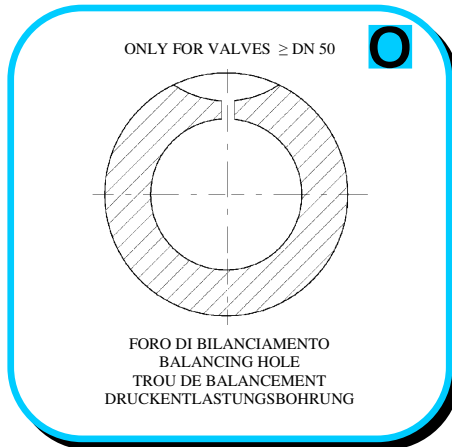

EXECUTION 6 - 16

S STANDARD

O OPTIONAL

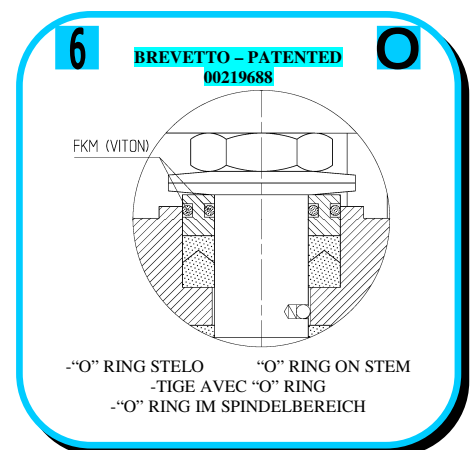
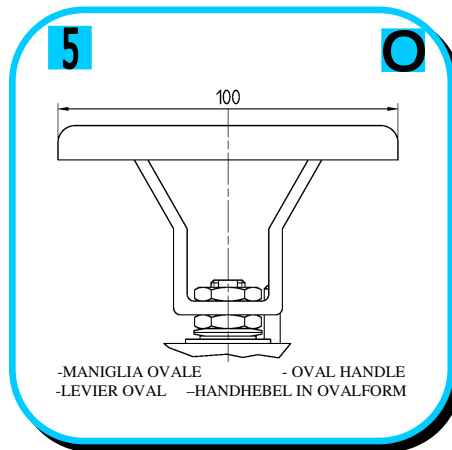
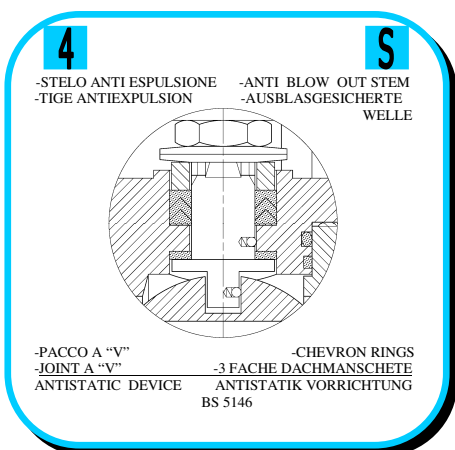
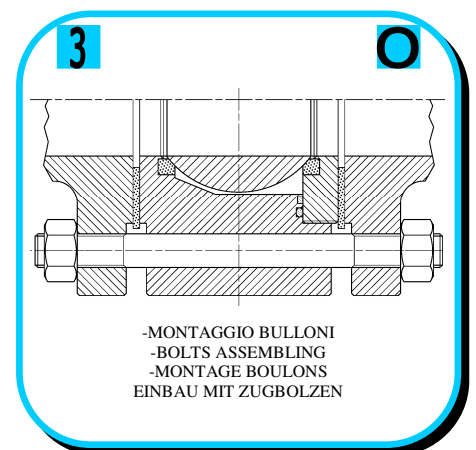
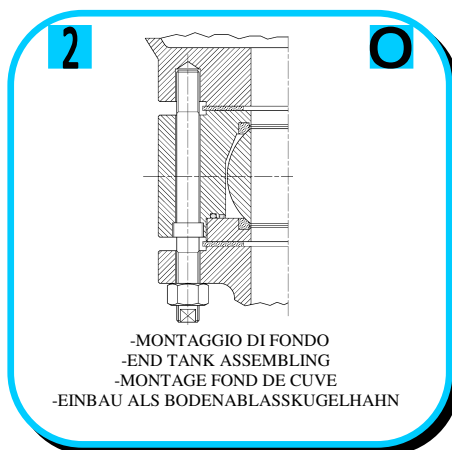
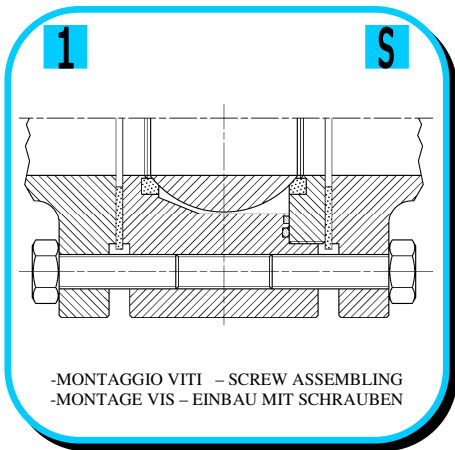

FX1/08 RIPRODUZIONE VIETATA - COPYRIGHT



ISO 9001:2008 by L.R.
 PED DIR. 97/23/EC by L.R.
 ATEX DIR. 94/9/EC by B.V.
 FIRE SAFE EXECUTION by L.R.
 ISO 15848 by TÜV
 ANTISTATIC DEVICE by L.R.
 FIRE SAFE TESTED ISO 10497 by L.R.

TYPE
FA1
 PN 10 ÷ 40
 ANSI 150 ÷ 300

VALVOLA A SFERA "CORPO PIATTO" PASSAGGIO TOTALE CON CAMICIA DI RISCALDAMENTO
 BALL VALVES "WAFER TYPE" FULL BORE WITH HEATING JACKET

ROBINETS A BOULE "WAFER" PASSAGE INTEGRAL AVEC ENVELOPPE FLANSCHKUGELHÄHNE IN "KOMPAKTBAUWEISE" VOLLER DURCHGANG MIT HEIZMANTEL

▪ ESECUZIONI ▪ EXECUTIONS ▪ EXECUTIONS ▪ AUSFÜHRUNGEN

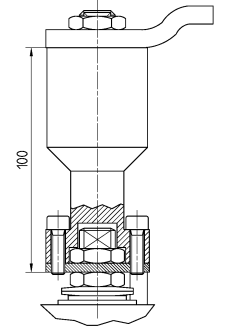
7 

-PROLUNGA STELO -STEM EXTENSION
 -TIGE PROLONGEE -SPINDELVERLÄNGERUNG

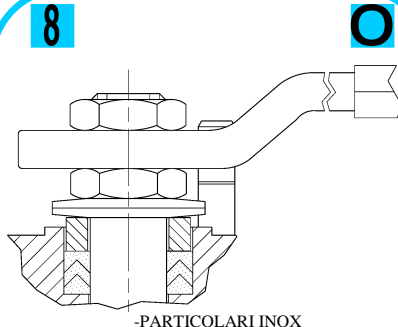
8 

-PARTICOLARI INOX
 -STAINLESS STEEL DETAILS
 -ACCESSOIRES EN INOX
 -EDELSTAHLTEILE

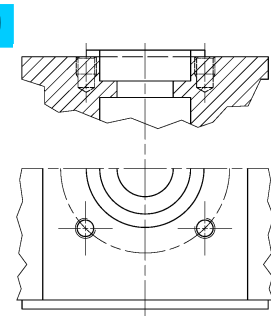
9 

-ATTACCO "ISO" -"ISO" FASTENING
 -SYSTEM "ISO" -ANSCHLUSS "ISO"

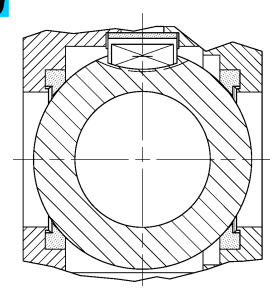
10 

-SFERA CONTENUTA -CONTENTS BALL
 -BOULE CONTENUE
 -NICHT RAUSRAGENDE KUGEL

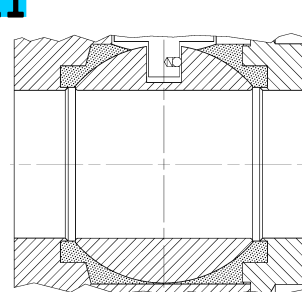
11 

-TENUTE INTEGRALE -POCKETLESS SEATS
 -TENUUE INTEGRALE -TOTRAUMARM
 -P.T.F.E. / R.T.F.E.

12 

FIRE SAFE
 ISO 10497 "ISO-FT"
 (BS 6755 / API 607)

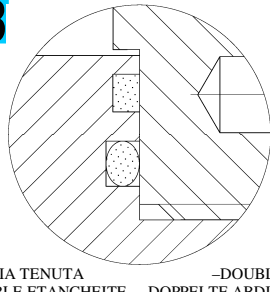
13 

-DOPPIA TENUTA -DOUBLE SEALS
 -DOUBLE ETANCHEITE -DOPPELTE ABDICHTUNG
 -GHIERA A BATTUTA -METAL BEATING RING
 -EMBOUT AVEC BATTUE MECANIQUE
 -METALLISCHER ANSCHLAG DES GEWINDEDRUCKRINGS

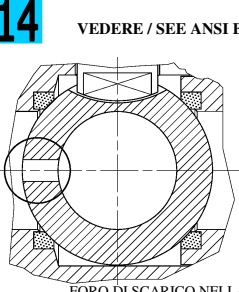
14 

VEDERE / SEE ANSI B 16.34

-FORO DI SCARICO NELLA SFERA
 -OVERPRESSURE HOLE INTO BALL
 -TROU DECOMPRESSION DANS LA BOULE
 -ENTLASTUNGSBOHRUNG IN DER KUGEL
 VALVOLA MONO DIREZIONALE
 MONO-DIRECTIONAL VALVE

FLUSSO
 FLOW

DIMENSIONS CHECK



16 

-FIRE SAFE ISO FT + "O" RING STELO
 -FIRE SAFE ISO FT + "O" RING ON STEM
 -SECURITE FEU ISO FT + TIGE AVEC "O" RING
 -FEUERSICHERE AUSFÜHRUNG ISO FT + "O" RING IM SPINDELBEREICH

FIRE SAFE ISO FT CERTIFICATION

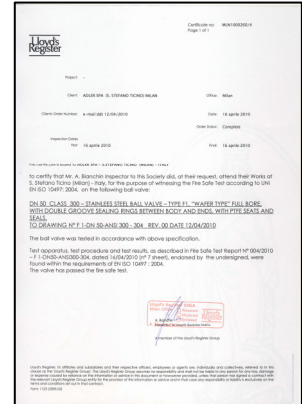

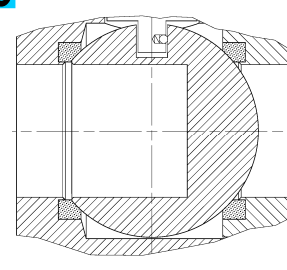
18 

-SFERA CIECA PER CAMPIONATURA
 -BLIND BALL FOR SAMPLING
 -PRISE-ECHANTILLON
 KUGEL FÜR PROBEENTNAHME



VITI D'ASSEMBLAGGIO PER FX1
ASSEMBLING SCREWS FOR FX1
VIS D'ASSEMBLAGE POUR FX1
MONTAGESCHRAUBEN FÜR FX1

TABLE
07

N° VITI – DIMENSIONE • N° SCREW – DIMENSIONS • N° VIS- DIMENSIONS • N° SCHRAUBEN-
 ABMESSUNGEN

EUROPEAN NORM

| DN PN | 10-15 | | 20 | | 25 | | 32 | | 40 | | 50 | | 65 | | 80 | | 100 | | 125 | | 150 | | 200 | |
|----------|-------|---------|---------|---------|---------|---------|---------|---------|---------|---------|---------|---------|---------|--|----|--|-----|--|-----|--|-----|--|-----|--|
| | 10 | 8 | M12 X30 | 8 | M12 X30 | 8 | M12 X35 | 8 | M16 X35 | 8 | M16 X35 | 8 | M16 X40 | | | | | | | | | | | |
| 16 | 8 | M12 X30 | 8 | M12 X30 | 8 | M12 X35 | 8 | M16 X35 | 8 | M16 X35 | 8 | M16 X40 | | | | | | | | | | | | |
| 25 | 8 | M12 X30 | 8 | M12 X35 | 8 | M12 X35 | 8 | M16 X40 | 8 | M16 X40 | 8 | M16 X40 | | | | | | | | | | | | |
| 40 | 8 | M12 X30 | 8 | M12 X35 | 8 | M12 X35 | 8 | M16 X40 | 8 | M16 X40 | 8 | M16 X40 | | | | | | | | | | | | |

ANSI METRIC

(STANDARD ADLER)

| Rating Ø | 1/2" | | 3/4" | | 1" | | 1 1/4" | | 1 1/2" | | 2" | | 2 1/2" | | 3" | | 4" | | 5" | | 6" | | 8" | |
|-------------|------|---------|---------|---------|---------|---------|---------|---------|---------|---------|---------|---------|---------|--|----|--|----|--|----|--|----|--|----|--|
| | 150 | 8 | M14 X30 | 8 | M14 X30 | 8 | M14 X30 | 8 | M14 X45 | 8 | M14 X35 | 8 | M16 X40 | | | | | | | | | | | |
| 300 | 8 | M14 X30 | 8 | M16 X30 | 8 | 316 X35 | 8 | M16 X40 | 8 | M20 X45 | 16 | M16 X40 | | | | | | | | | | | | |

ANSI B1.1 UNC

(ON REQUEST)

| Rating Ø | 1/2" | | 3/4" | | 1" | | 1 1/4" | | 1 1/2" | | 2" | | 2 1/2" | | 3" | | 4" | | 5" | | 6" | | 8" | |
|-------------|------|-------------|-------------|-------------|-------------|-------------|-------------|-------------|-------------|-------------|-------------|-------------|-------------|--|----|--|----|--|----|--|----|--|----|--|
| | 150 | 8 | 1/2 X 1 1/4 | 8 | 1/2 X 1 1/4 | 8 | 1/2 X 1 1/4 | 8 | 1/2 X 1 1/4 | 8 | 1/2 X 1 1/2 | 8 | 5/8 X 1 1/2 | | | | | | | | | | | |
| 300 | 8 | 1/2 X 1 1/4 | 8 | 5/8 X 1 1/4 | 8 | 5/8 X 1 1/2 | 8 | 5/8 X 1 1/2 | 8 | 3/4 X 1 3/4 | 16 | 5/8 X 1 3/4 | | | | | | | | | | | | |



PRZEDSTAWICIEL W POLSCE:

ARA
PNEUMATIK

53-012 Wrocław tel. 71 364 72 85
 ul. Wyścigowa 38 fax 71 364 72 83

www.arapneumatik.pl



ADLER SpA – VALVOLE A SFERA
 20010 S. STEFANO TICINO (MI) ITALY V.le BORLETTI, 14 Tel. +39/02974842.11 FAX +39/0297271698
 E-mail: adler@adlerspa.com <http://www.adlerspa.com>